



DYNAMIC STANDING FRAME

ACTIVALL™



USER MANUAL





Manufacturer takes responsibility for proper usage of the device only when the product was purchased from qualified Akces-Med employee or at specialized medical store!

AKCES-MED. Ltd. reserve the right to introduce technical and trading changes in the content of the instruction without warning.



Product marked with the CE sign is Class I medical device, of rule 1, consistent with the requirements of Regulation (EU) 2017/745 of the European Parliament and of the Council of 5 April 2017 on medical devices.



Akces-Med. Sp. z o.o. Company introduced quality management system ISO 13485 regarding production, sales and service. The system is certified by Det Norske Veritas.

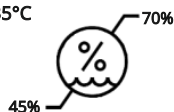
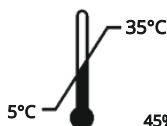



CONTENTS

1. The Purpose of user manual.....	5
2. Indications and contraindications for use.....	5
3. General characteristics of standing frame.....	7
3.1 Standard equipment.....	7
3.2 Additional equipment.....	8
4. Size table.....	11
5. Description how to assemble standing frame	12
6. Description how to use standing frame.....	15
7. Learning to walk.....	20
8. Additional equipment.....	22
9. The use of standing frame.....	35
9.1 Preparation of the patient.....	35
9.2 How to use standing frame.....	36
9.3 Upright position.....	37
10. Safety rules.....	39
11. Terms of warranty.....	41
12. Maintenance and cleaning.....	42
13. Labelling.....	46





INTRODUCTION

As far as this standing frame is concerned, it is highly beneficial to the process of daily rehabilitation which takes place not only in hospitals and rehabilitation wards but also in patient's house. This device enables the patient to stand and walk.

Moreover, children are able to take first steps and adults can either keep or regain fitness. Both light and stable frame is helpful in independent relocation in this device with slight involvement of the patient. The correct adjustment of braces makes the patient feel secure as well as comfortable during performing activities. Furthermore, this product may be used by patients in different age groups due to a vast array of sizes. This device plays a significant role because of the fact that patient has the possibility of gaining new experience and, more to the point, being independent as far as possible.

Remember to read this user manual carefully. You will find not only useful information but also guidelines regarding safe and effective use of the product.

If you have any questions or remarks, do not hesitate to contact with us:

Medical consultant: mobile +48 508 382 509

Akces-MED Sp. z o.o.: ph. +48 17 864 04 77

e-mail: export@akces-med.com

Thank you for purchasing our product!



CAUTION! Before using the product, user is obliged to familiarize himself/herself with user manual. Remember that complying with guidelines is highly important. It assures safety and extends durability as well as aesthetics of the device.





1. THE PURPOSE OF USER MANUAL



The present user manual contains basic information which is essential for :

- preparation before use,
- proper usage,
- maintenance, cleaning and guarantee conditions.

User manual should be kept in easily accessible place. It is designed for people who look after the disabled , and for both doctors as well as physiotherapists who operate the device. Before using the **ACTIVALL™** standing frame, user is obliged to familiarize himself/herself with user manual.

2. INDICATIONS AND CONTRINDICATIONS FOR USE

The dynamic standing frames are intended for people with orthopedic, neurological and cardiological diseases and for people after surgery who are unable to adopt and maintain a standing position on their own as a result of prolonged immobilization. Apart from securing and supporting the user in a standing position, the device is great help during everyday activities, but also during relearning and practicing walking skills. The selection of the appropriate size of the device depends on medical indications and anatomical parameters, regardless of the age of the user.

The device is recommended for people in the following cases:

- cerebral palsy – various types and forms,
- brain and spinal cord injuries with lower limbs paralysis and weakness,
- balance and motor coordination disorders with different etiology,
- demyelinating disease (e.g. multiple sclerosis – SM),
- meningocele,
- muscles diseases with weakness and paralysis (dystrophy, myasthenia gravis, myositis),
- genetic disorders,
- degeneration and neurological diseases,
- other condition connected with muscles weakness, paralysis and
- musculoskeletal disorders,
- after head and spinal cord injuries and spine trauma with paralysis and
- paresis.





Contraindications:

While standing upright, the user who is in a standing position should be closely monitored. The therapy should be discontinued in case of such side effects as: turning pale, sweating or fainting, joint strain and the resulting deformities of the body. Further proceeding should be consulted with the medical specialist or a physiotherapist who prescribed the treatment. The critical condition of the user is an absolute contraindication to standing upright.

- Relative contraindications for upright standing are: arterial hypertension at rest above 200/110 mmHg, pulmonary hypertension, cardiac arrhythmias, unstable asthma, unstable metabolic disorders, moderate heart valve disease.
- Any condition, such as a healing fracture or severe osteoporosis, that makes it impossible to bear the user's own bodyweight.
- Bone fracture with incomplete union, unless approved by a doctor.
- Postoperative restrictions on joint loading.
- Pain while standing in the standing frame (caused by subluxation or dislocation of the hip joint, overstretching of soft tissues or excessive pressure). Subluxation or dislocation of the hip joint in the absence of pain is not a contraindication.

People with significant flexion in the hip or knee joints, as well as with contractures in the ankle joint, may not be able to use the standing frame. Make sure that the position of the user in the standing frame does not cause excessive pressure or stretching of affected areas of the body. In such cases, standing upright may be contraindicated until a greater range of motion is achieved in the contracted joints.

In case of people with impaired cardiovascular system (arterial hypertension at rest above 200/110 mmHg, pulmonary hypertension, cardiac arrhythmias, moderate heart valve disease); respiratory system (unstable asthma) and unstable metabolic disorders, it is necessary to monitor the user while standing in order to prevent serious complications.





3. GENERAL CHARACTERISTICS OF STANDING FRAME

3.1. Standard equipment

1. Frame with castors equipped with brakes (2 back castors with friction brake)
2. Lower limbs separator
3. Adjustable pelvic support
4. Adjustable chest support
5. Pelvic harness





3.2. Additional equipment

 <p>AVL_002</p> <p>Belt for moving the patients AM-P</p>	 <p>AVL_011</p> <p>Castors with fixed direction of movement</p>	 <p>AVL_010</p> <p>Castors with blockade of reverse movement</p>
 <p>AVL_015 AVL_016 AVL_020</p> <p>Koło TANGO z hamulcem stop 75 mm / 125 mm / 100 mm</p>	 <p>AVL_015 AVL_016</p> <p>Tango wheels (75 mm / 125 mm)</p>	 <p>AVL_019</p> <p>Koło stalowe z hamulcem stop 125 mm</p>
 <p>AVL_112</p> <p>Forearm supports (2 pcs)</p>	 <p>AVL_141</p> <p>Hip supporting harness</p>	 <p>AVL_141</p> <p>Uprząż stabilizująca biodra z pasami</p>
 <p>AVL_142</p> <p>Narrowing pad for chest support</p>	 <p>AVL_143</p> <p>Narrowing pad for hip support</p>	 <p>AVL_201</p> <p>Lower limb immobilizer AM-TUD-KD</p>
 <p>AVL_202</p> <p>Lower limb immobilizer with kneecap protection AM-TUD-KD-02</p>	 <p>AVL_203</p> <p>Universal knee immobilizer AM-TUD-KD-03</p>	 <p>AVL_205</p> <p>Lower limb extension immobilizer OKD-03</p>





  <p>AVL_206</p> <p>Lower limb in 10° flexion immobilizer OKD-03/10</p>	  <p>AVL_207</p> <p>Lower limb in 20° flexion immobilizer OKD-03/20</p>	  <p>AVL_208</p> <p>Universal knee immobilizer OKD-01</p>
  <p>AVL_209</p> <p>Lower limb brace with polycentric 20° rom adjustment OKD-02</p>	  <p>AVL_210</p> <p>Post operative knee brace with polycentric 20° rom adjustment AM-KD-AM/2R</p>	  <p>AVL_211</p> <p>Post operative knee brace with 15° rom adjustment AM-KD-AM/1R</p>
  <p>AVL_212</p> <p>Foot-drop brace with frontal plate equalization AM-ASS-OS</p>	  <p>AVL_213</p> <p>Kafo brace for lower limb with splints 2r and dynamic foot made of carbon fibre AM-KDS-AM/2R</p>	  <p>AVL_216</p> <p>Knee and hip orthosis with rom adjustment OKD-14</p>
  <p>AVL_217</p> <p>The lower limb brace OKD-13</p>	  <p>AVL_218</p> <p>AVL_218 Dynamic lower limb brace raising the leg OKD-10</p>	  <p>AVL_430</p> <p>Castor bumper (4 pcs)</p>
  <p>AVL_621</p> <p>CROSS Module</p>	  <p>AVL_748</p> <p>Lower limb stabilizer</p>	  <p>AVL_749</p> <p>Separator of lower limbs</p>





5. SIZE TABLE

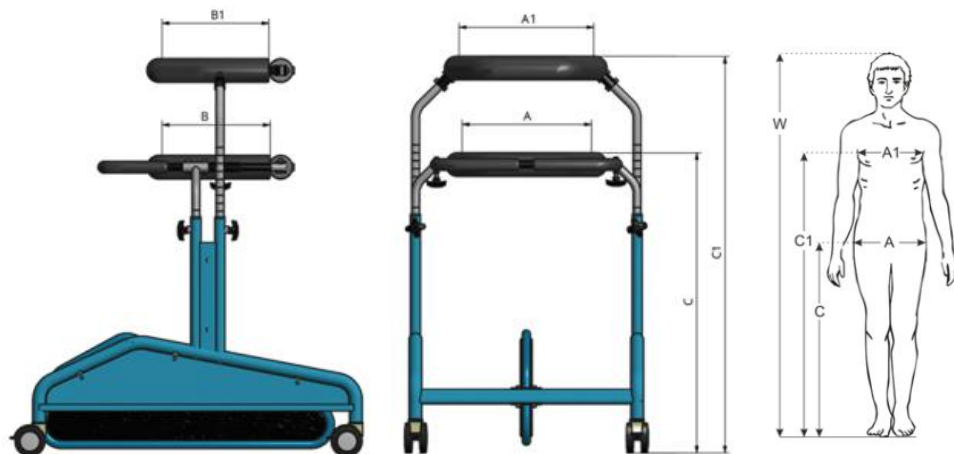

AVAILABLE SIZES

Symbol	Measurement	Unit	Size 1	Size 2	Size 3	Size 4	Size 5
W	Indicative user height**	[cm]	70-100	100-130	110-150	110-170	140-200
A/A1	Pelvic/chest support width	[cm]	26	28	31	37	42
C	Pelvic support height	[cm]	44-60	66-82	77-102	83-112	98-120
C1	Chest support height	[cm]	52-70	77-95	89-116	92-126	108-143
B/B1	Pelvic/chest support depth*	[cm]	22	25	27	29	35
	Pelvic/chest support perimeter	[cm]	87	97	106	124	144
	Maximum user weight	[kg]	25	40	60	80	95

WEIGHT AND DIMENSIONS OF THE DEVICE

Measurement	Unit	Size 1	Size 2	Size 3	Size 4	Size 5
Width	[cm]	59	60	63	66	74
Length	[cm]	73	84	84	91	98
Height	[cm]	54	79	90	96	112
Weight	[kg]	13,5	16,5	18	20,5	23

UWAGA: Measurement tolerance range is +/- 1 cm / ½ in..

UWAGA: Approximate values, depending on the product configuration.

*Measured without harness stabilizing the hips.

**The value cannot be main factor for selection of product size.





5. DESCRIPTION HOW TO ASSEMBLY STANDING FRAME

LIST OF ELEMENTS:



- (1) Chest brace
- (2) Pelvic brace
- (3) Frame with lower limbs separator
- (4) Columns (2 pcs)
- (5) Screw M6x40
- (6) Nut M6





To assemble **ACTIVAL™** you should: **STEP 1. Mount Chest brace (1)**



fig.1



fig.2



fig.3



fig.4



fig.5



fig.6



fig.7



fig.8





STEP 2. Attach the columns (4) to the standing frame's base (3). Columns should be fastened to the base in place of two holes by use of attached screws. This step does not concern size 1 of the stander. In size 1 the columns are attached to the base permanently.



STEP 3. Attach the pelvic support (2) to the base (3). In order to do that, insert the pelvic brace brackets into the first frame of the base.



CAUTION! After assemble of the pelvic support and adjusting it at the desired height be sure to tighten the knobs!



fig.15

STEP 3. Attach the chest support (1) to the base (3). In order to do that, insert the chest support brackets into the second frame of the base.



fig.16



CAUTION! After assembling of the chest support and adjusting it at the desired height be sure to tighten the knobs!



fig.17



6. DESCRIPTION HOW TO USE STANDING FRAME



CAUTION! The adjustment of standing frame to the patient should be always made by suitably trained staff. Suitably trained persons have to assist patient while doing exercises.



CAUTION! Before use of standing frame you should block the wheels' brakes and unlock pelvic support and chest support. Not blocking the wheels of standing frame can cause its shifting while uprising, which results in patient's fall, breakage or body's injury. During coming into standing frame or getting out of it you mustn't rest on rear clamping-rings' locks while they are being opened. The attempts of overloading the opened locks of clamping-ring can cause a fall of device or deformation which results in incorrect functioning of fastener lock.

6.1. Chest Support

6.1.1. In order to adjust the height of the chest support, you should loosen the knobs and set the desired height. Afterwards tighten the knobs.



fig.18





Height of chest support depends on patient's control over his chest. If control is good, patient keeps upright position, it does not require his big effort and patient feels safe, the clamping-ring can be fixed below. Nevertheless, in such case a walking process should begin with fixing the clamping-ring under one's arm and then you can gradually level down. To regulate the height of chest support use knobs A.

6.2. Pelvic Support

6.2.1 In order to adjust the height of the pelvic support, you should loosen the knobs and set the desired height. Afterwards tighten the knobs.



fig.19

6.2.2 Pelvic support can be adjusted horizontally. In order to change the pelvic support depth, you should unscrew the knobs placed located under the support and set the desired position (so that the holes on the frames overlap). Afterwards tighten the knobs.



fig.20



fig.21

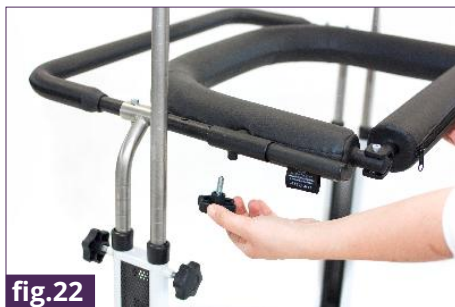

fig.22





Pelvic support should be fixed at the level of trochanter of lower limbs. After fixing height you must regulate position of pelvic support (regulation forward and backward). The proper position of trunk and pelvis depends on precise adjusting. The ideal position is one line of arms, trunk and hips.



CAUTION! While regulating the height of the pelvic support and chest support you cannot exceed the double lines on cantilever.



fig.23

6.3. Pelvic Harness

Pelvic harness protects the patient from falling out of the device. In order to attach it to the pelvic support, fasten the harness buckle on the pelvic support.



fig.24





CAUTION! While buttoning buckles please place your attention on characteristicsound "CLICK" which informs about correct fastening.

CAUTION! Pelvis' harness cannot be treated as a seat, it serves as a protection from the fall only in case of faintness!



Straight position is safe and comfortable. While standing in this position patient is being adapted to the vertical position as well as sense of equilibrium, internal organs, circulation system are being adopted to the new conditions and to bigger load. Patient can stand in straight position quite long time, can simultaneously do exercises or simple everyday-life activities etc. The device is safe and will remain solid and stable even if patient loses his consciousness

6.4. Castors with friction brake

Using the castors with friction brake enables patient to fit the speed of moving in **ACTIVALL™**. It is of importance during the first exercises in dynamic standing frame. Knob A regulates strength of stress of a metal strip which brake the rotating castors. While first steps in **ACTIVALL™** it is recommended to use friction brake in order to move slower. When patient gets more confidence, the resistance of break can be reduced.



Knob A



7. LEARNING TO WALK

If the patient feels well you can unblock the brakes and start practicing. If the patient feels well you can unblock the brakes and start practicing. While using off-road version you should check if swapped chassis is suitable matched and fastened. Also check the brakes and their assembly.

By shoving the trunk and pelvis ahead, with both hands on handles (handles are additionally protected from sliding of hands and coated with washable spongy material) or on supports (ADDITIONAL EQUIPMENT). Then the equilibrium point will Shift forward, which stimulate walking process. This position should not be forced, because then can bring about the opposite effect.

The first steps should be done forward and then backward and finally to diverse directions.

While walking, firstly normal steps should be done and then fester or slower steps.

We recommend to use special paths in order to help in orientation for both courageous and not courageous type of patients.

After practicing in verticalizer **ACTIVALL™** patient must return safely on wheelchair, chair, armchair, bed etc.





CAUTION! Patient cannot leave standing frame independently. Therapist is obliged to patient's insurance at side or at the back!

CAUTION! You should pay your special attention to block the wheels of wheelchair and protect the chair or armchair before patient is going to seat on it. Backing off of the seat can cause patient's fall or injuries.

CAUTION! Construction assumptions involve operation of the standing frame on a smooth ground. It is forbidden to overcome obstacles like thresholds or other when the standing frame is loaded. Failure to above recommendations may lead to feet separator damage (separator detachment or roller deflection). Damage caused by improper operation are not subject to warranty repair.



8. ADDITIONAL EQUIPMENT

8.1. **REF AVL_011** Castors with blockade of reverse movement

Using the castors with blockade of reverse movement is of great importance while first steps in the dynamic standing frame. Screwing tight the knob A blocks a bend of castors and patient can move forward only.

Knob A



8.2. **REF AVL_010** Castors with blockade of reverse movement

Using of castors with blockade of reverse movement is very useful in learn walking when patients are start to walk. To unblock blockade please lift up a holdfast and push metal rim under the holdfast (fig 2 and 3). To block again stick out a metal rim from under the holdfast (fig 1).

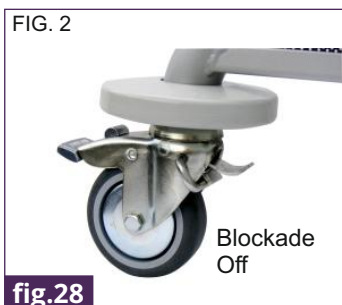



8.3. **REF AVL_012** Forearm supports

Perfect for people with limited control of the upper body, provide additional side support. You can order 1 or 2 pieces.



8.4. **REF AVL_748** Lower limbs stabilizer

Lower limbs stabilizer converts the standing frame into fully functional static version. Knee supports can be adjusted to the user's height.



8.5. **REF AVL_749** Separator of lower limbs

Separator of lower limbs prevents crossing of the legs during using of the dynamic function of the device.



8.6. **REF AVL_002** Belt for moving the patients AM-P

Durable and ergonomic design greatly facilitates daily care of the patient. Belt has three comfortable and sturdy handles and strong plastic buckle.



**8.7. [REF AVL_015] [REF AVL_016] Tango Wheel (75 mm, 125 mm)**

Very quiet and extremely durable. Front castors with directional and reversing lock, rear castors with directional lock and brake.

**fig.34****8.8. [REF AVL_142] [REF AVL_143] Narrowing pad for chest/hip support**

Cushions narrowing the chest/hip support provide additional stabilization of the trunk. Attached to the chest/hip support. They help to better fit the device to the user's needs.. Cushions are fastened by use of Velcro straps.

**fig.35****fig.36****8.9. [REF AVL_141] Hip supporting harness**

Harness stabilizing the hips is attached to the both side of hips support. It provides a proper stabilization of the pelvis and secures the user from falling down. Thanks to the special buckles it allows for the lower limb immobilizers/tutors assembly.

**fig.37**



8.10. **[REF AVL_201] Lower limb immobilizer AM-TUD-KD**

It prevents from knee hyperextension and is highly recommended in the rehabilitation process of the patient.



fig.38

8.11. **[REF AVL_202] Lower limb immobilizer with kneecap protection AM-TUD-KD-02**

Indicated for patients with lower limbs muscles weakness. It prevents from knee hyperextension and is highly recommended in the rehabilitation process of the patient.



fig.39

8.12. **[REF AVL_203] Universal knee immobilizer AM-TUD-KD-03**

It prevents from knee hyperextension and is highly recommended in the rehabilitation process of the patient.



fig.40

8.14. **[REF AVL_205] Lower limb extension immobilizer OKD-03**

It prevents from knee hyperextension and is highly recommended in the rehabilitation process of the patient.



fig.41



**8.15. [REF AVL_206] Lower limb in 10° flexion immobilizer OKD- 03/10**

It keeps the knee joint in moderate 10° flexion which prevents from knee hyperextension.

**8.16. [REF AVL_207] Lower limb in 20° flexion immobilizer OKD- 03/20**

It keeps the knee joint in moderate 20° flexion which prevents from knee hyperextension.

**8.17. [REF AVL_208] Universal knee immobilizer OKD-01**

It is fast, efficient and comfortable solution for the patient in the case of the knee joint instability.

**8.18. [REF AVL_209] Lower limb brace with polycentric 20° rom adjustment OKD-02**

It stabilizes and relieves the knee joint. Equipped with a 2R side clock that enables you to adjust the range of motion of the knee joint at 20°.



**8.19. [REF AVL_210] Post operative knee brace with polycentric 20° rom adjustment AM-KD-AM/2R**

It stabilizes and relieves the knee joint. Equipped with a 2R side clock that enables you to adjust the range of motion of the knee joint at 20°.

**fig.46****8.20. [REF AVL_211] Post operative knee brace with 15° rom adjustment AM-KD-AM/1R**

It stabilizes and relieves the knee joint. Equipped with a 2R side clock that enables you to adjust the range of motion of the knee joint at 15°.

**fig.47****8.21. [REF AVL_212] Foot-drop brace with frontal plate equalization AM-ASS-OS**

AFO type orthotics, perfect in the case of peroneal nerve palsy and feet paresis.

**fig.48****8.22. [REF AVL_213] Kafo brace for lower limb with splints 2r and dynamic foot made of carbon fibre AM-KDS-AM/2R**

KAFO type orthotics, stabilizes the knee joint and compensates for the lost flexion function.

**fig.49**



8.23. [REF AVL_216] Knee and hip orthosis with rom adjustment OKD-14

The orthotics stabilizes the hip and knee joint in the frontal and sagittal plane.



fig.50

8.24. [REF AVL_217] The lower limb brace OKD-13

It allows for safe and independent movement of the patient e.g. from wheelchair to bed.



fig.51

8.25. [REF AVL_218] Dynamic lower limb brace raising the leg OKD-10

The orthotics activates the normal gait pattern by lifting and moving weakened lower limb.



fig.52





8.23. **REF AVL_621** CROSS Module



ATTENTION! It is possible to assemble the turning wheels in the front of the standing frame and in the back of the standing frame.

Components:



- (1) Basket x 1 pc
- (2) Flat washer (overlay) x 2 pcs
- (3) Large flat washer (underlie) x 2 pcs
- (4) Hex key 5 (allen wrench) x 1 pc
- (5) Hex key 8 (allen wrench) x 1 pc
- (6) Spanner 10 x 2 pcs
- (7) Swivel wheels x 2 pcs
- (8) Frame with brakes x 1 pc



To assemble the CROSS module you should:

STEP 1. Remove the standard wheels of the standing frame:

a) Use the spanner keys 10 **(6)** to unscrew the wheels (fig.53-55).



b) Use The Hex key (allen wrench 8) **(5)** to remove the fork (fig.56).



STEP 2. The next step is assembling the swivel wheels **(7)**. To do this, first remove the wheel from the fork with the hex key 8 **(5)** (fig. 57, 58).





Then, put the following elements in the correct order: first put the flat washer (overlay) **(2)** and large flat washer (underlie) **(3)** on the wheel fork, and then stick the screw from the bottom which you have after removing the standard wheels **(STEP 1, pt. b, fig. 46)**. Afterwards, tighten the wheel fork to the stander frame with the use of the hex key **8 (5)** (fig. 59-60).

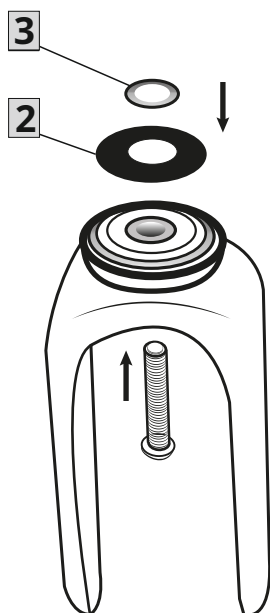

STEP 3. Re-assemble the wheel in the fork – insert the screw in the circular-shaped opening as shown in the picture (fig.61).





Next - Insert the self-locking nut on the other side of the fork - in the hexagonal shaped insert - and tighten the screw with the hex key 8 (5) (fig. 62, 63).



STEP 4. We assemble large wheels with the use of the screws which you have after disassembling the standard wheel fork (**STEP 1, pt. b, fig. 46**). Tighten the screws with the hex key 8 (5) (fig. 64-66).





STEP 5. Then using a phillips screddriver unscrew the 2 little screws at the end of the hip support frame (fig.67). After loosening the knobs (fig.68), remove the support along with the pelvic harness by using the phillips screwdriver (fig.69).



STEP 6 . To disassemble the remaining part of the structure you should unscrew 4 screws with the hex key 5 (**4**) and the spanner key 10 (**6**) (fig. 70) and remove the remaining part (fig. 71). In place of the standard frame we assembly the frame with brakes (**8**) (fig.72, 73).





STEP 7. The frame with brakes (8) must be secured with 4 screws which you have after disassembling the remaining part of the hip support (STEP 6) (fig.74). Next we place the hip support frame and harness on it (fig.75), and once again we screw the two small screws at the ends of the support frame. (fig.76). Tighten the hip support with the knobs.



STEP 8. The last step is to assemble the handy basket (1).

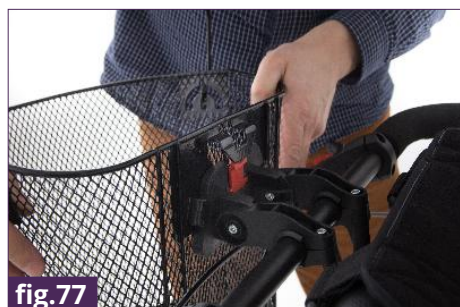



9. THE USE OF STANDING FRAME



CAUTION! ACTIVALL™ has to be used with compliance to guidelines included in this user manual. Remember to use the product only with someone who is trained and knowledgeable. Do not forget to prepare both product as well as patient before using **ACTIVALL™**!

9.1. Preparation of the patient

Before using the product, it is essential to make sure that:

- patient's outfit is light and comfortable sporty clothes are advisable;
- shoes should be comfortable and, moreover, they should stabilize ankle;
- due to hygienic reason and to avoid abrasion it is advisable for the patient to always wear clothes when using the device, skin must not be naked especially in places of regular contact with upholstery;
- drains, bags, catheters etc. if applied, have to be secured to function properly and not to disturb during using the product;
- if it is necessary for a patient to wear orthopedic supply (collar, corset, orthosis, shoes) if it is recommended by doctor.



CAUTION! Outfit should protect patient's skin from direct contact with upholstery as well as other parts of equipment.

CAUTION! Only doctor can make a decision concerning using any kind of orthopedic supply!





9.2. How to use standing frame

Before use it is necessary to:

- Unfold the device;
- Place the device on a flat surface allowing for easy access to the standing frame at a safe distance from sources of ignition and high temperature
- Make sure that all parts are serviceable, correctly mounted and stable;
- Check the condition of castors and brakes;
- Block brakes;
- Adjust the device to patient's measurements;
- Place patient in the device;
- Fasten all elements which stabilize patient;
- Mount additional equipment.



CAUTION! Remember to make sure that all belts and locking are correctly adjusted and fastened. Check also if fastenings from adjustable elements are firmly tightened.

Patient cannot leave standing frame independently!

To leave **ACTIVALL™** the following should be done (hints for doctors of rehabilitation):

1. Block the wheels of dynamic standing frame using brakes.
2. At the back of dynamic standing frame put the wheelchair, chair, armchair.
3. Unfasten opening of both pelot-pads.
4. Seat patient on wheelchair, chair, armchair etc gently.

Equipment works correctly only when the device is adjusted according to patient's height as well as weight. Remember to take all these measurements into account while purchasing the product. Correct adjustment is the most important due to the fact that only then the product is safe. It is forbidden to force child to keep specific position because he/she will feel uncomfortable and it may lead to wrong posture.





9.3. Upright position

CAUTION!

The length of time for upright position process is different for each patient. It is recommended to extend this time during the initial period (adaption period for the change of position). Either doctor or physiotherapist can make decision concerning the length of upright position process. Upright position process has to be always performed under the supervision of trained person!

It is recommended to divert patient's attention during upright position process by:

- manipulation games
- educational games



CAUTION! It is highly important to adjust the device to the patient before using it!

CAUTION! Make sure that all belts as well as fastenings from adjustable elements are correctly adjusted and fastened.

CAUTION! It is forbidden to leave the patient unattended!

CAUTION! Only trained staff can adjust standing frame to the patient!



CAUTION! As far as first upright standing is concerned, it takes place in rehabilitation, neurosurgery or orthopedics wards. Moreover, it has to be performed together with doctor and physiotherapist due to the fact that medical problems may appear during first treatments such as fainting, drop in blood pressure, dizziness etc. Upright standing is continued in home together with trained staff (rehabilitation technician, district nurse, trained family members).

CAUTION! Incorrect adjustment of the device can lead to side effects such as: fainting, body deformities, overloading joints. It is highly advisable to adjust the device before every use of a standing frame. This adjustment has to be done only by a trained person or therapist. If any of these side effects appear, it is highly important to stop the upright position process, take out the patient from the device and lie him/her down. If these undesirable side-effects still occur it is necessary to contact doctor. If these side effects disappeared, remember to inform doctor so as to make decision concerning further upright position process.





10. SAFETY RULES



CAUTION! Dynamic standing frame **ACTIVALL™** has to be used in compliance with guidelines in this user manual.

It is highly important to consult either doctor or physiotherapist in order to make right decision concerning the choice of **ACTIVALL™** and its size. It is also essential to familiarize with the guidelines described in user manual before using the device.

1. Before use it is necessary to:

- make sure that there are no damages or different faults which could endanger patient's life; check if all parts are working and are correctly mounted and, moreover, check if they are not broken;
- check if all screws, knobs and all glued, sewed or tapped parts are tightened;
- check if brakes are operating correctly;
- check if buckles are operating correctly;
- always use safety belts, Velcro tapes should overlap min. 8cm;
- adjust the device according to patient's measurements and needs;
- make sure that all movable parts and knobs for adjustments are stable and locked;
- secure patient with the aid of elements such as pelvic harness. It is highly important to secure patient because it safeguards him/her from falling out.

2. It is forbidden to use the device for different purposes that it is intended to.

3. It is forbidden to use the device when it is damaged or any part is missing.

4. It is forbidden to leave the patient unattended.

5. The device should be used only when there is someone who is trained and knowledgeable.

6. It is forbidden to leave the device and the patient on unstable ground unattended, even if the brake is engaged.

7. It is forbidden to either go up or down the stairs; it doesn't matter if the patient is placed in the device or not.





8. It is important to engage brake during getting into and getting out the device.
9. Make sure that all limbs are not close to spokes or other adjustable elements.
10. Please pay your attention when approaching to sources of fire or sources of high temperature during using the device. Moreover, device shouldn't be stored in rooms with high humidity.
11. Secure the device during transportation in order to avoid any possible damages. Manufacturer doesn't take responsibility for damages which appeared due to improper preparation of the device during transportation.
12. Before using the product, remove all paper and plastic packaging. The packaging is not a toy! Keep away from children and animals.



Incorrect product adjustment can lead to such side effects as fainting, body deformities, joint overload, etc. If the abovementioned symptoms occur, stop using the product immediately, take the user out of the product and lay them down. If the undesirable symptoms persist, contact a physician immediately. If the symptoms have disappeared, inform the attending physician about this fact in order to make a decision about the further rehabilitation process.

This device can be only used inside the buildings.

The device contains small parts which children may swallow.

Do not use a product that has any signs of damage, tearing or wear. Only an undamaged product and proper use guarantee its right and safe working. If the product is damaged, discontinue use and contact the manufacturer.

It is forbidden to make any changes concerning device's structure due to the fact that it is dangerous and it results in losing warranty.





Under no circumstances should an unqualified person repair or alter the product and its construction, as the health and safety of the user depend on it as well as it will lead to the loss of warranty.

The weight of user should not be bigger than maximal weight described on page 11 where you will find information regarding this issue.

Serious incidents involving this device should be reported both to manufacturer and to the competent authority in your country.

11. TERMS OF WARRANTY

- 1) AKCES-MED Sp. z. o. o sells products free from manufacturing defects or faults.
- 2) Manufacturer gives the purchaser 24-month guarantee from the date of purchase. All defects revealed during warranty period will be repaired free of charge.
- 3) All defects which appear after warranty period can be repaired only when the user will pay for it. This rule doesn't apply to refunded products - user can ask National Health Refund for refund.
- 4) Manufacturer claims that the product can be used for 48 months. User can use this product after this period only when he/she will send the device to manufacturer so as to service it. Next, manufacturer determines again how long the product can be used and, moreover, the date of the next service will be determined.
- 5) If product is damaged, please contact our dealer or AKCES-MED customer service (ph. 17/864 04 77)





12. MAINTENANCE AND CLEANING

ACTIVALL™ should be kept clean and used in compliance with the manufacturer's recommendations. The device should be kept in clean, dry and ventilated room. Maintenance as well as cleaning have to be performed at least once a month. Regular cleaning and maintenance of device are indispensable to maintain its correct functionality as well as safety.

It is highly advisable to remember about proper maintenance in order to extend product's aesthetics. So as to do that, it is essential to comply with these guidelines:

1. It is recommended to clean upholstery with the aid of cleaning product, soft sponge and warm water. If you use sponge which is too wet, stain may get bigger, upholstery may be destroyed. It is necessary to remember that the excess of dampness should be removed from fabric before next cleaning. Please rinse upholstery with warm water and clean white cloth once stain is removed.
2. It is forbidden to soak upholstery!
3. It is forbidden to clean upholstery with the aid of hard brushes.
4. It is forbidden to clean upholstery with strong chemical agents such as solvent or caustic chemicals.



CAUTION! Akces-MED. Sp z o. o takes no responsibility for damages caused by use of wrong clearing agent.

5. It is forbidden to soak upholstery during cleaning. Remember that upholstery has to be always dry before using.
6. It is forbidden to clean, make any changes and maintain stroller during using it.
7. All metal as well as plastic elements should be cleaned by hand with the aid of general cleaning products. Remember to familiarize yourself with cleaning product's leaflet.





8. Pelvic harness should be hand washed in water not exceeding 40°C, using mild detergents. After washing, dry it at room temperature.
9. In the case of using the standing frame by many patients in hospitals, rehabilitation wards or other places, and regulations of these facilities do not provide otherwise, the push handles should be disinfected before passing the device to other patient.



CAUTION! Remember that upholstery has to be always dry before using!

Before using it is necessary to:

- clean wheels;
- check if base as well as wheels are correctly mounted; check if brake stops turning wheel;
- make sure that all wooden parts e.g. tray don't have splinters;
- check if stroller construction is free of breaks or any kinds of deformities;
- check if all movable parts are working and all screws, nuts, knobs etc. are correctly tightened;
- check if belts, vests, trunk belts, feet stabilizing belts etc are not frayed; check if buckles and clamps work correctly.



CAUTION! Manufacturer takes responsibility only for hidden faults or damages which appeared despite the fact that user complied with the guidelines.

CAUTION! In case of any damages, it is essential to contact the person who sold you the product.





TECHNICAL INSPECTION

Technical inspections should be performed regularly. Before servicing, the product should be thoroughly cleaned to reveal any hidden damage.

Frequency	What should be checked? What should be done?		Remarks
Before each use.	General condition of the product.	Check: <ul style="list-style-type: none"> the entire product for any visible damage, cracks or mechanical defects,, if the product complete, if all bolts, screws, knobs, nuts and other elements of the construction are complete and tightened.. 	In case of any damage or defects, discontinue the use of the product and contact your Supplier/Distributor or the Manufacturer.
	Wheels and brakes.	Check: <ul style="list-style-type: none"> if the wheels are properly mounted and if they are not damaged, if the brake is blocking the spinning wheel, if the wheels are not dirty. If necessary, clean the wheels. 	In case of any damage or defects, discontinue the use of the product and contact your Supplier/Distributor or the Manufacturer.
	Fastening of the construction elements.	Check all the mechanisms of the product and its moving parts. Check in particular: <ul style="list-style-type: none"> if the seat is properly mounted (if applicable), if the wheels are properly mounted (if applicable), if the elements securing the user are properly mounted and if they work well (if applicable), if all the moving parts are complete, work properly, do not jam, if the adjustment mechanisms of the following elements work properly (if applicable): headrest, backrest, seat, abduction block, armrests, footrests. 	In case of any damage or defects, discontinue the use of the product and contact your Supplier/Distributor or the Manufacturer.
	Upholstery elements.	Check: <ul style="list-style-type: none"> if there is any damage, tears, rips, loose seams or deformations on the upholstery elements, if the stabilizing straps, vests or safety belts are not frayed or twisted and if the buckles work properly, if the stabilizing straps, vests or safety belts work correctly and do not unfasten under pressure or when pulled. 	In case of any damage or defects, discontinue the use of the product and contact your Supplier/Distributor or the Manufacturer.
Once a week.	Product cleaning.	If the frame and upholstery get dirty (dusty, muddy, etc.) during everyday use, wipe them with a damp cloth without detergents. Remove dirt (e.g. hair, food remains, etc.) from the moving parts of the product.	The product should be cleaned when necessary, but at least once a week. Do not use any chlorine based cleaners or methylated spirit. Before using the product, check if the upholstery is dry.





Frequency	What should be checked? What should be done?		Remarks
Once a month.	Wheel axles, quick connectors (if applicable).	Check: <ul style="list-style-type: none"> if the wheels are rolling and if they are not loose. To maintain the wheels, apply a small amount of a preservative-lubricant between the axle and the wheel hub. Check if you can easily remove and attach the wheels. 	Clean the wheels when dirty. In case of any damage or defects, discontinue the use of the product and contact your Supplier/Distributor or the Manufacturer.
	Product construction connectors (welding, threading, soldering)	Check: <ul style="list-style-type: none"> the condition of the product frame in the places of joining (welds, threads, soldering). 	In case of any damage or defects, discontinue the use of the product and contact your Supplier/Distributor or the Manufacturer.
	Tires/innertubes (if applicable).	Check: <ul style="list-style-type: none"> tire wear condition. Check for visible damage. Check tire pressure (if applicable). 	If the tire pressure is too low, inflate them to the correct level. In case of any damage or defects, discontinue the use of the product and contact your Supplier/Distributor or the Manufacturer.
Once every 6 months.	Construction moving parts.	Check: <ul style="list-style-type: none"> if the moving parts of the construction have not been damaged. Maintain them using a proper cleaning agent. 	In case of any damage or defects, discontinue the use of the product and contact your Supplier/Distributor or the Manufacturer.
	Product labeling.	Check: <ul style="list-style-type: none"> if the marking and labels are readable. 	In case of any damage or defects, discontinue the use of the product and contact your Supplier/Distributor or the Manufacturer.
After the life time of the product finishes.	Detailed product check.	Check the product.	The manufacturer specifies the life time of the product, which is given in the user manual. After the given period, the user may use the product only if it is sent back to the manufacturer to be checked first. After that, the manufacturer will re-define the life time of the product and the date of the next check.

The list of all spare parts is available for download after selecting a product on www.akces-med.com.



13. LABELLING

12.1. Symbols

	Declaration that the product meets the essential requirements		Protect from sunlight
	Catalog number		Storage temperature limitation
	Serial number		Relative humidity storage
	Please read the manual instructions before use		Dry vertically
	Attention!		Do not chlorinate
	Producer		Do not iron
	Production date		Do not dry in a drum dryer
	The product does not contain		Do not bleach
	Store in a dry place		Careful! delicate content
	Prohibition of use without fastened safety belts		Prohibition to leave the patient without care during use of the product
			Product designed for indoor use

12.2. Example of identification plate

QR code - after scan you are directed to the website of the product

Producers address

Name of product in Polish

Name of product in English

Date of production

Maximum allowable product loading

Labeling - look above

Serial number in the form of a bar code

Serial number

The identification plate contains the following information:

- AKCESMED** logo and website: www.akces-med.com
- ACTIVALL 1** (Name of product in Polish)
- ACTIVALL 1** (Name of product in English)
- 05 2014** (Date of production)
- MAX LOAD: 25 kg** (Maximum allowable product loading)
- CE** mark (Labeling - look above)
- AVL 001/P/1/AA** (Serial number)



MANUFACTURER



Akces-MED Sp. z o.o.

Jasionka 955B
36-002 Jasionka
tel. (17) 864 04 77
e-mail: export@akces-med.com
BDO: 000031619

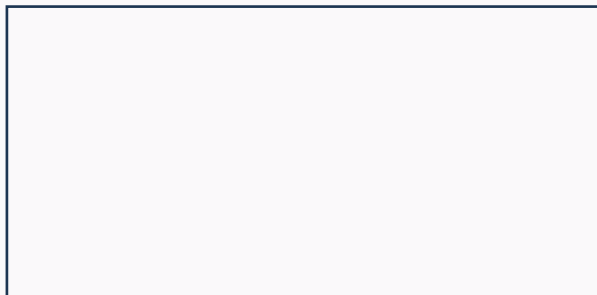

Authorised Dealer



akces-med.com

Date of issue: 27.07.2007
The last update: 10.09.2021
© Sławomir Wroński 2021